

ITEM NO.	QTY.	PART NO.	DESCRIPTION
7	1	24800	valve plate with valves

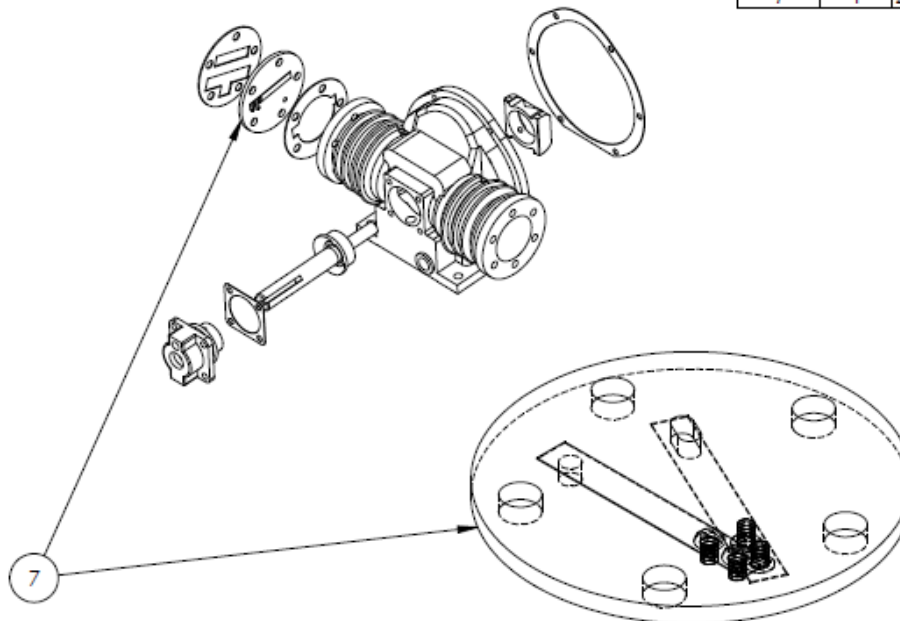

Cross References
 GE cat # 132A1221P10
 ITE/ABB cat # 042L009-11
 Keystone (Philadelphia - early) cat # 414A
 Keystone (Darby - later) cat # 10160

Note:
 This valve plate assembly is also used on
 the Model A compressor if it gets converted
 to a Model D.

PROPRIETARY AND CONFIDENTIAL
 THE INFORMATION CONTAINED IN THIS
 DRAWING IS THE SOLE PROPERTY OF
 BREAKER SERVICE INC. ANY
 REPRODUCTION IN PART OR AS A WHOLE
 WITHOUT THE WRITTEN PERMISSION OF
 BREAKER SERVICE INC. IS PROHIBITED.
 COPYRIGHT 2003

BREAKER SERVICE INC			
800-826-5250 office 888-267-7690 fax			
Valve plate with valves for Keystone Model D air compressor			
This part # is for one valve plate Two plates req'd per compressor			
REV A	DWG. NO. 24800	REV. 0	
SCALE 1:1	Date: 02-02-2003	SHEET 1 OF 1	